

LARGE CAN TYPE



Series

Snap-in Terminal Type, Miniature Sized



- Withstanding 5000 hours application of high ripple current at 85°C.



SPECIFICATION

Item	Characteristic										
Operation Temperature Range	-40 ~ +85°C										
Rated Working Voltage	160 ~ 450VDC										
Capacitance Tolerance (120Hz 20°C)	±20%(M)										
Leakage Current (20°C)	$I \leq 0.02CV$ or 3 (mA) *Whichever is smaller after 5 minutes I : Leakage Current(μA) C : Rated Capacitance(μF) V : Working Voltage(V)										
Surge Voltage (20°C)	W.V.	160	200	250	350	385	400	420	450		
	S.V.	200	250	300	400	420	450	470	500		
Dissipation Factor (tan δ) (120Hz 20°C)	Rated Voltage (V)	160	200	250	350	385	400	420	450		
	tan δ	0.15	0.15	0.15	0.15	0.15	0.15	0.15	0.15	0.15	
Low Temperature Stability	Impedance ratio at 120Hz										
	Rated Voltage (V)	160~250					350~450				
	-25°C / +20°C	4					6				
Load Life	After 5000 hours application of W.V. and +85°C ripple current value, the capacitor shall meet the following limits. (DC + ripple peak voltage ≤ rate working voltage)										
	Capacitance Change	≤ ±20% of initial value									
	Dissipation Factor	≤ 175% of initial specified value									
	Leakage current	≤ initial specified value									
Shelf Life	At +85°C, no voltage application after 1000 hours, the capacitor shall meet the limits for load life characteristics. (With voltage treatment)										

TERMINAL TYPE

▲ P.C.B. TERMINAL (SNAP IN)
SYMBOL:W(φ22~35)

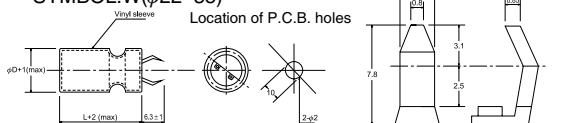

▲ LUG TERMINAL
SYMBOL:G(φ22~35)

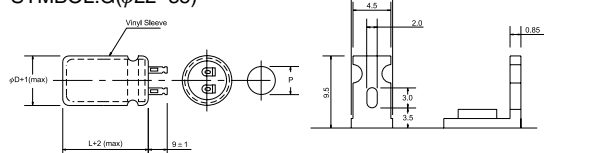

▲ P.C.B. TERMINAL
SYMBOL:V(φ25~35)

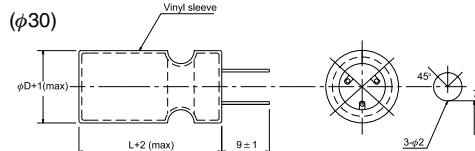
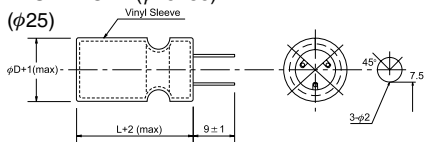

(φ35)
A.B. blank terminals

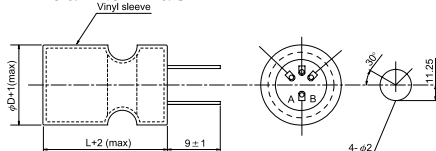

RIPPLE CURRENT COEFFICIENTS

Temperature(°C)	40	60	70	85
Multiplier	1.80	1.40	1.20	1.00

Frequency(Hz)	60	120	400	1k	10k
W.V.	Multiplier				
≥160V	0.80	1.00	1.10	1.30	1.40



7170 N. Ridgeway
Lincolnwood, IL 60712
Ph: 847-675-1865
Fax: 847-675-3345
Email: sales@icd-sales.com
Website: www.icd-sales.com



● CASE SIZE & MAX RIPPLE CURRENT

Case size : D x L (mm)
 Max ripple current : A(rms) 85°C 120Hz

μF	V(Code) Code φD	160 (2C)				200 (2D)				250 (2E)			
		22	25	30	35	22	25	30	35	22	25	30	35
150	151									25			
										0.94			
220	221	25				25				30	25		
		1.13				1.13				1.24	1.24		
330	331	30				30	25			40	30		
		1.44				1.44	1.55			1.65	1.65		
470	471	35	30			40	30	25			40	30	
		1.85	1.85			1.96	1.96	1.96			2.16	2.06	
560	561										45	35	25
											2.50	2.50	2.50
680	681	45	35	30			40	30				40	30
		2.47	2.47	2.47			2.58	2.47				2.78	2.78
1000	102		45	35	30			40	35				40
			3.19	3.19	3.19			3.40	3.61				3.71
1500	152			45	40				45				
				4.33	4.33				4.74				
2200	222				50								L(mm)
					5.97								R.C.

μF	V(Code) Code φD	350 (2V)				385 (2X)				400 (2G)			
		22	25	30	35	22	25	30	35	22	25	30	35
68	680	25				25				25			
		0.63				0.63				0.63			
100	101	30	25			30	25			30	25		
		0.81	0.82			0.81	0.82			0.81	0.82		
120	121									35	30		
										0.95	0.95		
150	151	40	30			40	30			40	35	25	
		1.13	1.03			1.13	1.03			1.13	1.13	1.13	
180	181										40	30	
											1.24	1.24	
220	221	50	40	30		50	40	30		40	35		
		1.44	1.44	1.44		1.44	1.44	1.44		1.44	1.55		
270	271										45	35	25
											1.65	1.65	1.65
330	331		50	40	30		50	40	30			45	35
			1.96	1.96	1.96		1.96	1.96	1.96			2.06	2.06
390	391											50	40
												2.27	2.27
470	471			50	40			50	40				45
				2.58	2.58			2.58	2.58				2.68
560	561				45				45				50
					2.88				2.88				2.99
680	681				50				50				L(mm)
					3.12				3.12				R.C.



7170 N. Ridgeway
 Lincolnwood, IL 60712
 Ph: 847-675-1865
 Fax: 847-675-3345
 Email: sales@icd-sales.com
 Website: www.icd-sales.com

● CASE SIZE & MAX RIPPLE CURRENT

Case size : D x L (mm)
 Max ripple current : A(rms) 85°C 120Hz

μF	V(Code) Code φD	420 (2Y)				450 (2W)			
		22	25	30	35	22	25	30	35
47	470					25			
						0.53			
68	680					30	25		
						0.67	0.68		
100	101	30	25			40	30	25	
		0.81	0.82			0.91	0.89	0.93	
120	121	40	30						
		0.97	0.97						
150	151	45	35	25		50	40	30	
		1.11	1.14	1.15		1.20	1.24	1.13	
180	181	50	35	30			45	35	30
		1.30	1.25	1.30			1.34	1.34	1.34
220	221		40	35				40	30
			1.45	1.50				1.55	1.55
270	271		50	35	30			45	35
			1.70	1.67	1.76			1.85	1.85
330	331			45	35				40
				2.02	2.04				2.16
390	391			50	40				
				2.29	2.29				
470	471				45				50
					2.66				2.78
560	561				50				L(mm)
					3.02				R.C.